

MONUMENT RECORD
State of Indiana - County of Monroe

Section: 08

Township: 8 North

Range: 1 East

Corner ID: Sa Cr G-07

Monument Description & Remarks: Found Sandstone with "+" (halfway up hill) at center of section. Stone was moss covered and measured 0.5' x 0.8' x 0.4'. Earth disturbance from uprooted tree (tree is gone) approximately 11' in a northerly direction; downed single strand barb wire fence N 03° W.

References on file in the County Surveyor's Office: Survey by Raymond Graham, RLS No. 9978, dated 4/4/97, 54.09 acres; Legal Survey Book No. 2, Page 380.

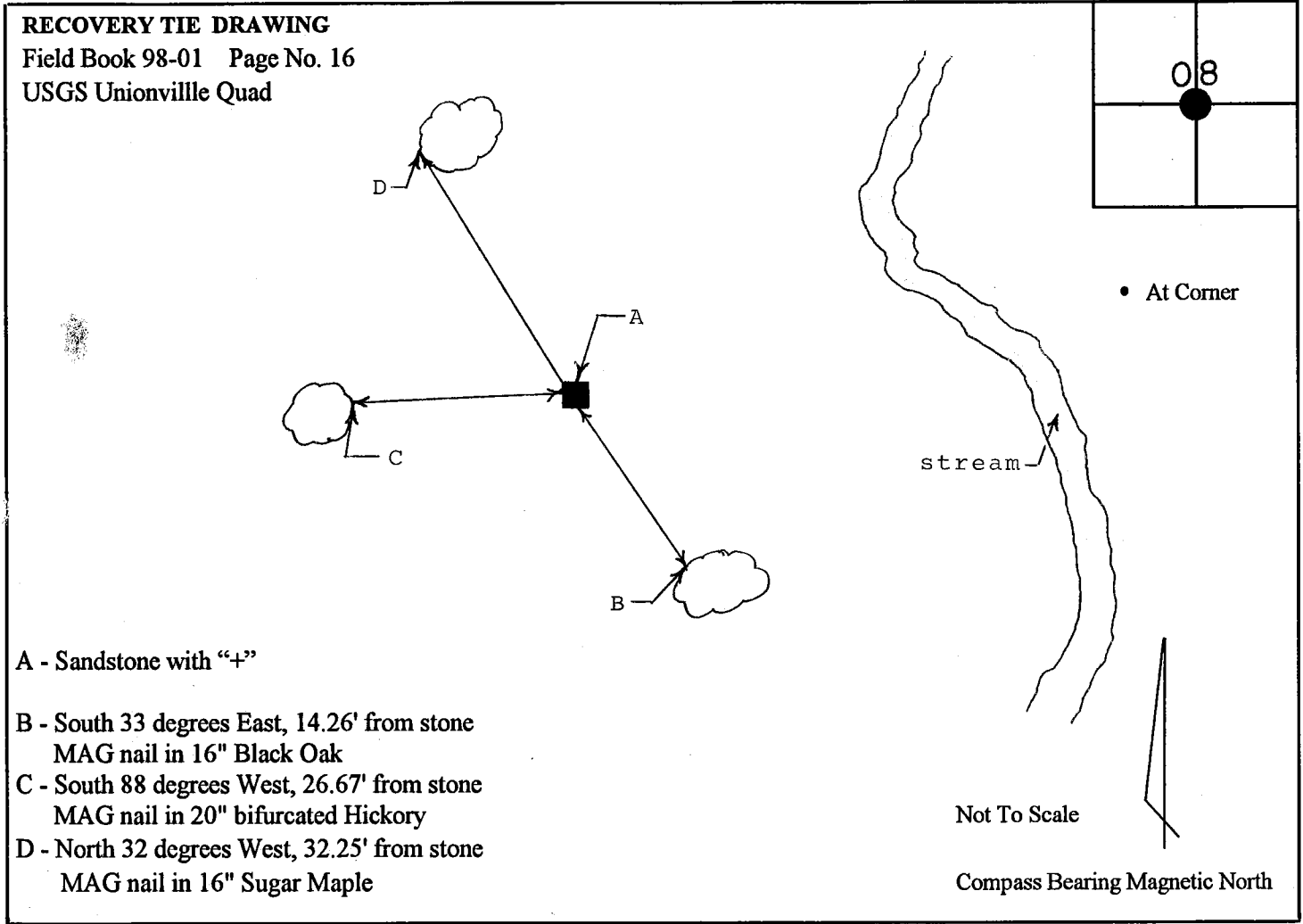

I, Kevin P. Enright, Monroe County Surveyor, hereby certify that this document was prepared under my direction in accordance with the provisions of Section 36-2-12-11 of the Indiana Code; and the above data is given under my hand and seal this 5th day of January, 1998.

Kevin P. Enright

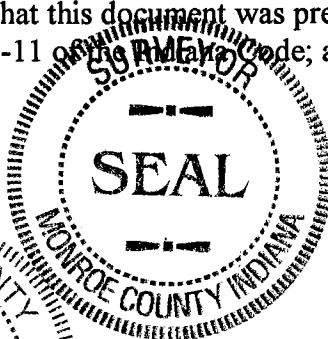

Administered by: Surveyor Review Board

